

How to Patch Bottom Board

The black material enclosing the base of a mobile home is known by a variety of names: bottom board, belly board, black board, etc. Typically, the material used is asphalt-impregnated fiberboard, asphalt-impregnated fiberglass cloth or heavy tar paper. All serve the same purpose:

- Prevent moisture infiltration
- Insulate the subfloor
- Keep out animals and insects

Any tear or hole should be repaired immediately.

STEP 1: Assess the Damage

Before repairing, figure out what caused the damage. If moisture buildup caused the tear, locate and repair the source of the leak. Replace damaged insulation and flooring. If pests caused the problem, get rid of them and their nests.

STEP 2: Locate Joists

Remove damaged bottom board back to the center of the nearest joist.

STEP 3: Build Frame

Rough in a smaller frame to be used as a nailing surface between the nearest joists. Have one side of this frame attached to a joist. (Some servicers chose not to install the small frame, but it is the most secure way to repair.)

STEP 4: Cut Patch

Cut a new piece of bottom board, larger than the damaged area. Size the patch to fit the new frame or, if you are not using a frame, to fit completely over the damaged area.

STEP 5: Cover Hole

Screw the patch to the frame, over the existing bottom board. If the damage is extensive, you might size the patch to attach directly to the joists. If you are using the self-adhesive Flex-Mend (page 14), you will not need any screws. Simply peel back the liner and press to the hole. For very small tears, consider using the Flex-Mend mending tape.

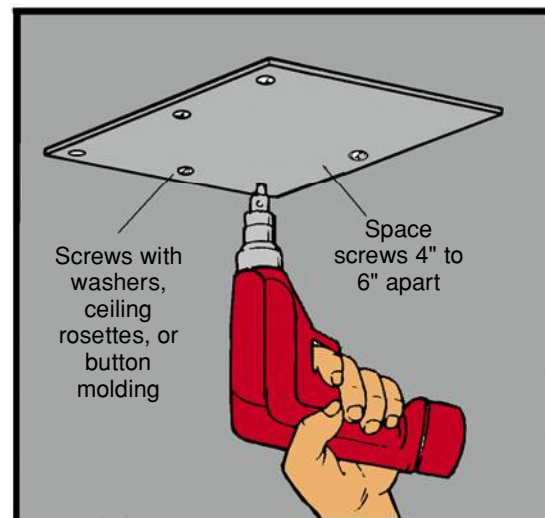
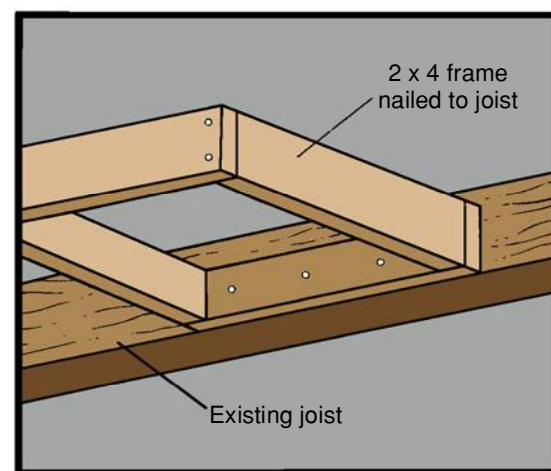
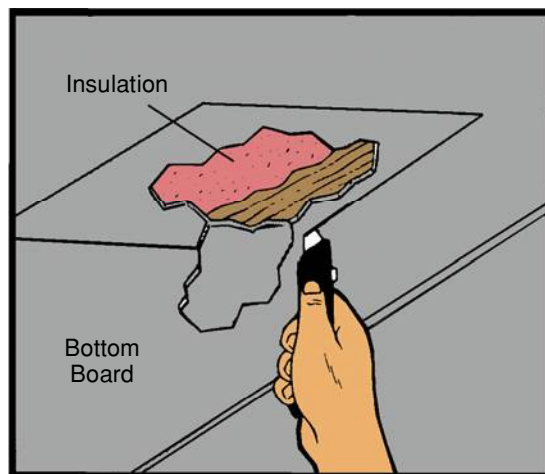

*Reproduced with permission from *The Mobile Home Fix-It Guide*, copyright 1993 by Foremost Real Estate Company, Grand Rapids, MI.